



ENGAGING WITH RESILIENCY AND SUSTAINABILITY:

CAPACITY BUILDING AT THE LOCAL GOVERNMENT LEVEL IN SOUTHEAST LOUISIANA
CITY OF GRETNA

CONTEXT

THE CITY OF GRETN, LOUISIANA IS A COMMUNITY OF APPROXIMATELY 18,000 DIRECTLY ACROSS THE MISSISSIPPI RIVER FROM DOWNTOWN NEW ORLEANS. THE CITY WAS FIRST SETTLED IN THE EARLY 19TH CENTURY AND EXPANDED CONSIDERABLY DURING THE LATTER HALF OF THE 20TH CENTURY. DEVELOPMENT PATTERNS ARE REFLECTIVE OF MANY AMERICAN CITIES, WITH A HISTORIC CORE AND MORE RECENT OUTWARD SUBURBAN EXPANSION. PRIOR TO THE PAST SEVERAL YEARS, THE CITY NEVER ENGAGED IN ANY COORDINATED PLANNING - LAND USE, ENVIRONMENTAL, INFRASTRUCTURE OR OTHERWISE. IN THE PRECARIOUS CONTEXT OF LOUISIANA'S DISAPPEARING WETLANDS, CLIMATE CHANGE AND INCREASED STORM INTENSITY, THE CITY IS TAKING ITS FIRST STEPS TO ENGAGE THE PARADIGM SHIFT TO A MORE SENSITIVE URBAN ECOLOGY.

CONFRONTING THE SAME SET OF STRUCTURAL VULNERABILITIES AS NEW ORLEANS, THE CITY EXPERIENCES FREQUENT FLOODING AND HAS CONSIDERABLE, COST-PROHIBITIVE INFRASTRUCTURE NEEDS. RECOGNIZING THE NEED FOR LONG-RANGE, COMPREHENSIVE PLANNING, THE CURRENT ADMINISTRATION HAS CHOSEN TO PROACTIVELY ENGAGE IN PARRALEL PROCESSES AND PROJECTS THAT EMBRACE SUSTAINABILITY AND RESILIENCY FRAMEWORKS WHILE BUILDING CAPACITY FOR THE CITY TO FORMALIZE AND CARRY THESE PRACTICES FORWARD. THE CITY UNDERSTANDS THAT THIS IS A LONG-TERM PROCESS, BUT SEES THE NEED TO CONFRONT THESE ISSUES IMMEDIATELY AS REFLECTED IN THE WORK ACCOMPLISHED TO-DATE. AS THE FOLLOWING PAGES DEMONSTRATE, EMBRACING THESE FRAMEWORKS FACTORS INTO ALL FACETS OF ADMINISTRATIVE AND POLITICAL DECISION MAKING - FROM EMPLOYEE ORGANIZATION TO CAPITAL PROJECT PLANNING AND BUDGETING. THE CITY OF GRETN IS ON THE FRONT LINES OF ENGAGING THESE TOPICS AND PROVIDES INSIGHT INTO FOUNDATIONAL CAPACITY BUILDING TOOLS FOR LOCAL GOVERNMENTS CONFRONTING THE MYRIAD ISSUES ASSOCIATED WITH ENVIRONMETNAL CHANGE.

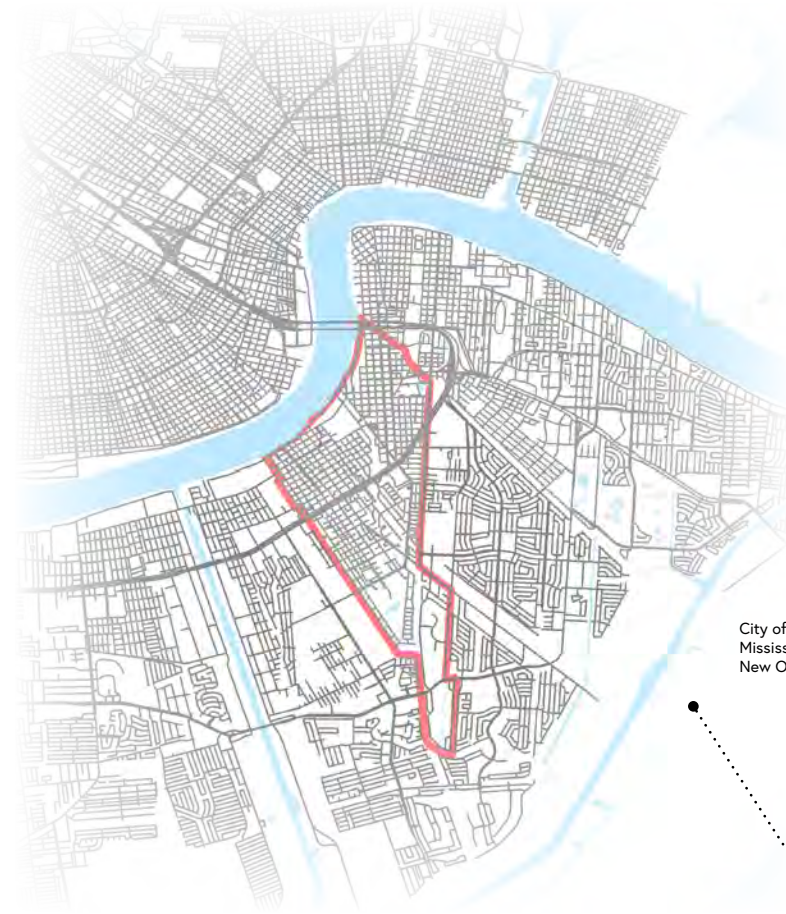

City of Gretn relative to the Mississippi River and Downtown New Orleans

A NEWLY ELECTED MAYOR AND CITY COUNCIL RECOGNIZE THE NEED FOR LONG-RANGE STRATEGIC PLANNING SUPPORTED BY A COMMUNITY-WIDE VISIONING PROCESS TO DEFINE THE FUTURE AND CONFRONT CRITICAL INFRASTRUCTURE NEEDS.

TIMELINE

OCTOBER 2014



BATTURE CONCEPT

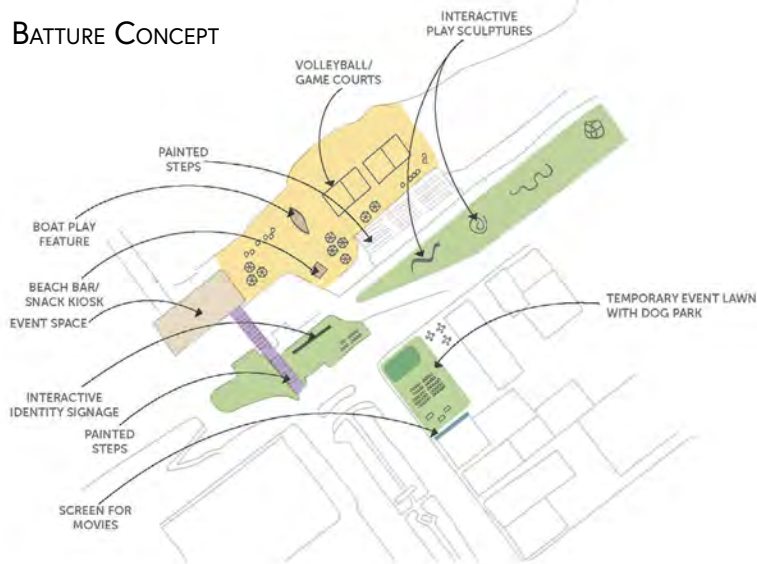

Downtown public space concept development courtesy of Project for Public Spaces

PLAZA CONCEPT

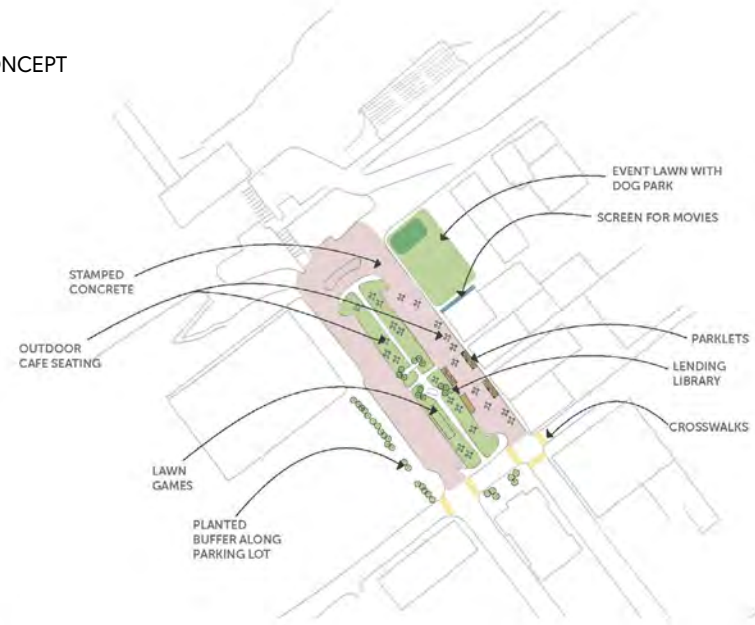

Proposed Concept Diagram



THE CITY ENGAGES THE TULANE REGIONAL URBAN DESIGN CENTER TO FACILITATE A PUBLIC PROCESS AND PROVIDE DESIGN RECOMMENDATIONS FOR ITS FIRST SMALL-AREA PLAN, FOCUSING ON THE DOWNTOWN AREA.

THE LOUISIANA OFFICE OF COMMUNITY DEVELOPMENT - DISASTER RECOVERY UNIT APPROVES CDBG-DR FUNDING FOR ITS FIRST COMPREHENSIVE PLAN AND DEVELOPMENT CODE REWRITE.

THROUGH THE EPA'S BUILDING BLOCKS FOR SUSTAINABLE COMMUNITIES TECHNICAL ASSISTANCE PROGRAM, THE CITY HOSTS THE NEW YORK BASED PROJECT FOR PUBLIC SPACES TO FACILITATE STAKEHOLDER AND COMMUNITY CONVERSATION FOR CREATING A WALKABLE, VIBRANT DOWNTOWN GRENTA. THE CITY USES THIS PROCESS TO LEVERAGE ITS WORK WITH THE TULANE REGIONAL URBAN DESIGN CENTER.

MARCH 2015

AUGUST 2015

SEPTEMBER 2015

GRETTA DOWNTOWN 2020

WORKING WITH IT'S METROPOLITAN PLANNING ORGANIZATION, THE CITY FINALIZES A COORIDOR STUDY FOR 5TH STREET, ITS FORMER MAIN STREET, INCORPORATING GREEN INFRASTRUCTURE AND COMPLETE STREETS CONCEPTS. THE CITY RECIEVES FUNDING COMMITMENTS FOR CONSTRUCTION AND BEGINS DESIGN.

JANUARY 2016

WORKING WITH THE TULANE REGIONAL URBAN DESIGN CENTER, THE CITY RELEASES THE **GRETTA DOWNTOWN 2020 PLAN** - STRATEGIC URBAN DESIGN RECOMMENDATIONS FOR THE CITY'S CENTRAL PUBLIC SPACES, WITH EM-PHASIS ON ENVIRONMENTAL AND SOCIAL CONSIDERATIONS.

MARCH 2016

APRIL 2016

MAYOR BELINDA C. CONSTANT IS APPOINTED CO-CHAIR OF THE MISSISSIPPI RIVER CITIES AND TOWNS INITIATIVE (MRCTI), A GROUP OF 80 MAYORS DEDICATED TO SUSTAINABLE DEVELOPMENT ALONG THE NATION'S MOST CRITICAL NATURAL ASSET. THE APPOINTMENT PROVIDES CITY LEADERSHIP CONTINUED EXPOSURE TO SUSTAINABILITY AND RESILIENCY ISSUES.

Consntruction drawings for the City's first green infrastructure demonstration project.

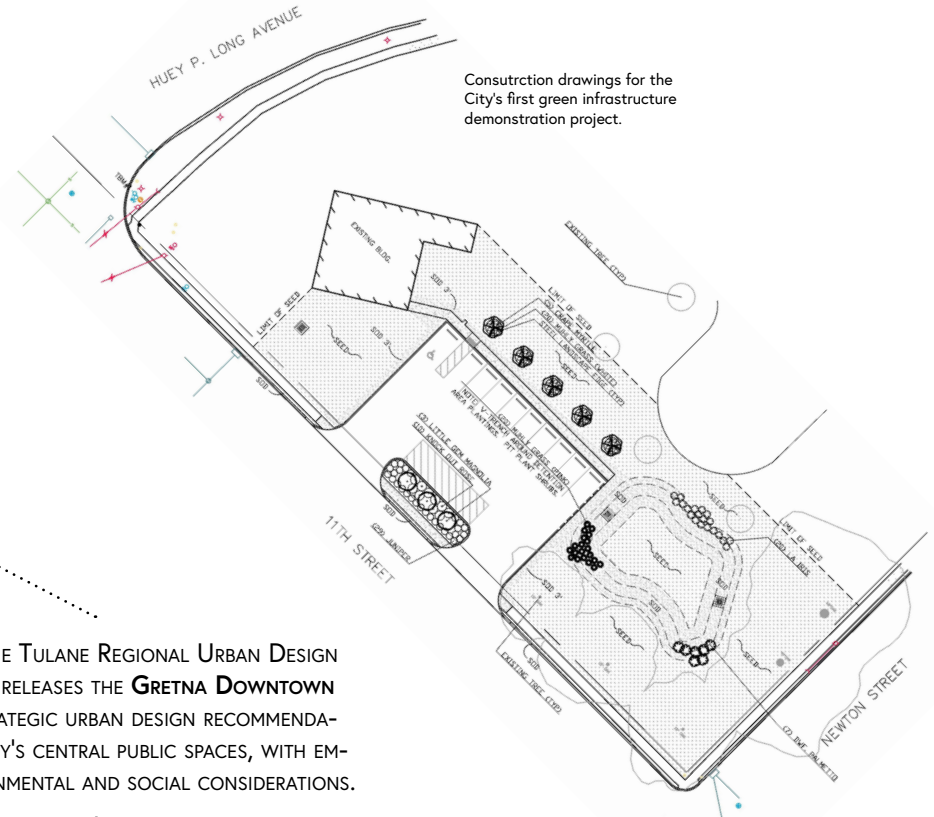

THE CITY COMPLETES CONSTRUCTION ON ITS FIRST GREEN INFRASTRUCTURE DEMONSTRATION PROJECT - A BIORETENTION AREA SERVING A PUBLIC FACILITY PARKING LOT, LANDSCAPED WITH NATIVE AND WATER TOLERANT SPECIES.

JULY 2016



Final concept for the City's
Downtown Drainage Project -
with an anticipated Spring 2018
construction start.

THE CITY FINALIZES FUNDING FOR ITS DOWNTOWN DRAINAGE PROJECT. THE PROJECT REFLECTS SUSTAINABLE DESIGN APPROACHES TO WHAT WAS A CONVENTIONAL DRAINAGE PROJECT AND CAPTURES THE RECOMMENDATIONS FROM THE PROJECT FOR PUBLIC SPACES AND **GRETNA DOWNTOWN 2020** PLAN. FEATURES INCLUDE A REVAMPED CENTRAL PUBLIC PLAZA WITH STORMWATER MANAGEMENT FEATURES AND NUMEROUS CURB EXTENSIONS WITH BIORETENTION FACILITIES.

BASED OFF OF THE ANTICIPATED **GRETNA COMPREHENSIVE PLAN** RECOMMENDATIONS, THE CITY LAUNCHES ITS DEVELOPMENT CODE REWRITE, WITH EXPECTED MANDATES FOR STORMWATER BEST MANAGEMENT PRACTICES (BMPs) INCLUDING GREEN INFRASTRUCTURE, AND SMART GROWTH PRINCIPLES THAT PROMOTE A MORE SUSTAINABLE AND RESILIENT BUILT ENVIRONMENT.

THE CITY COUNCIL INTRODUCES AN ORDINANCE TO CREATE THE CITY'S FIRST RESILIENCE DISTRICT, THE 25TH STREET RESILIENCE DISTRICT, MANDATING SUSTAINABLE ENVIRONMENTAL DESIGN CONSIDERATIONS FOR ALL FUTURE PROJECT DEVELOPMENT AND IMPLEMENTATION. THE DISTRICT CORRELATES WITH ONE OF THE COUNTRY'S HIGHEST CONCENTRATIONS OF NATIONAL FLOOD INSURANCE PROGRAM (NFIP) REPETITIVE AND SEVERE REPETITIVE LOSS PROPERTIES.

AUGUST 2017

OCTOBER 2017

THE CITY RELEASES THE DRAFT **GRETNA COMPREHENSIVE PLAN**, WITH NUMEROUS KICK OFF AND SHORT TERM (YEARS 1-5) IMPLEMENTATION TASKS TO BUILD UPON THE RESILIENCY AND SUSTAINABILITY CAPACITY ESTABLISHED IN THE PAST THREE YEARS, INCLUDING, BUT NOT LIMITED TO:

- THE ADOPTION OF A NEW UNIFIED DEVELOPMENT CODE
- CREATION OF A CHIEF RESILIENCY OFFICER (CRO) POSITION THAT HAS BROAD OVERSIGHT OVER LAND USE PLANNING AND CAPITAL PROJECT INITIATIVES
- DEVELOPING OUR FIRST CAPITAL IMPROVEMENT PLAN (CIP) AND ALLOCATING INCREASINGLY APPROPRIATE SHARES OF THE BUDGET TO CAPITAL PROJECTS
- REDUCING THE RISK PROFILE OF APPROXIMATELY 40 PERCENT OF THE CITY'S REPETITIVE AND SEVERE REPETITIVE LOSS PROPERTIES.
- DEVELOPING AND ADOPTING A COMPLETE STREETS POLICY AND ORDINANCE
- COORDINATING A PUBLIC RELATIONS STRATEGY TO COMMUNICATE THE IMPORTANCE OF RESILIENCY AND SUSTAINABILITY ISSUES TO RESIDENTS AND BUSINESSES
- INTRODUCTION OF CLEAN /ALTERNATIVE FUEL VEHICLES INTO THE CITY'S FLEET AND OTHER WASTE REDUCTION STRATEGIES
- RIPARIAN ZONE RESTORATION ON ALL PUBLICLY MANAGED WATER BODIES
- MANDATING LOW IMPACT DESIGN SOLUTIONS ON PUBLIC PROJECTS



GRETNA
comprehensive plan

NOVEMBER 2017